

ST. JOSEPH CATHOLIC  
CEMETERY

NORTH SANDUSKY AVE.  
(M-90)

CITY OF SANDUSKY  
GREENWOOD CEMETERY

SCALE 1"=30'

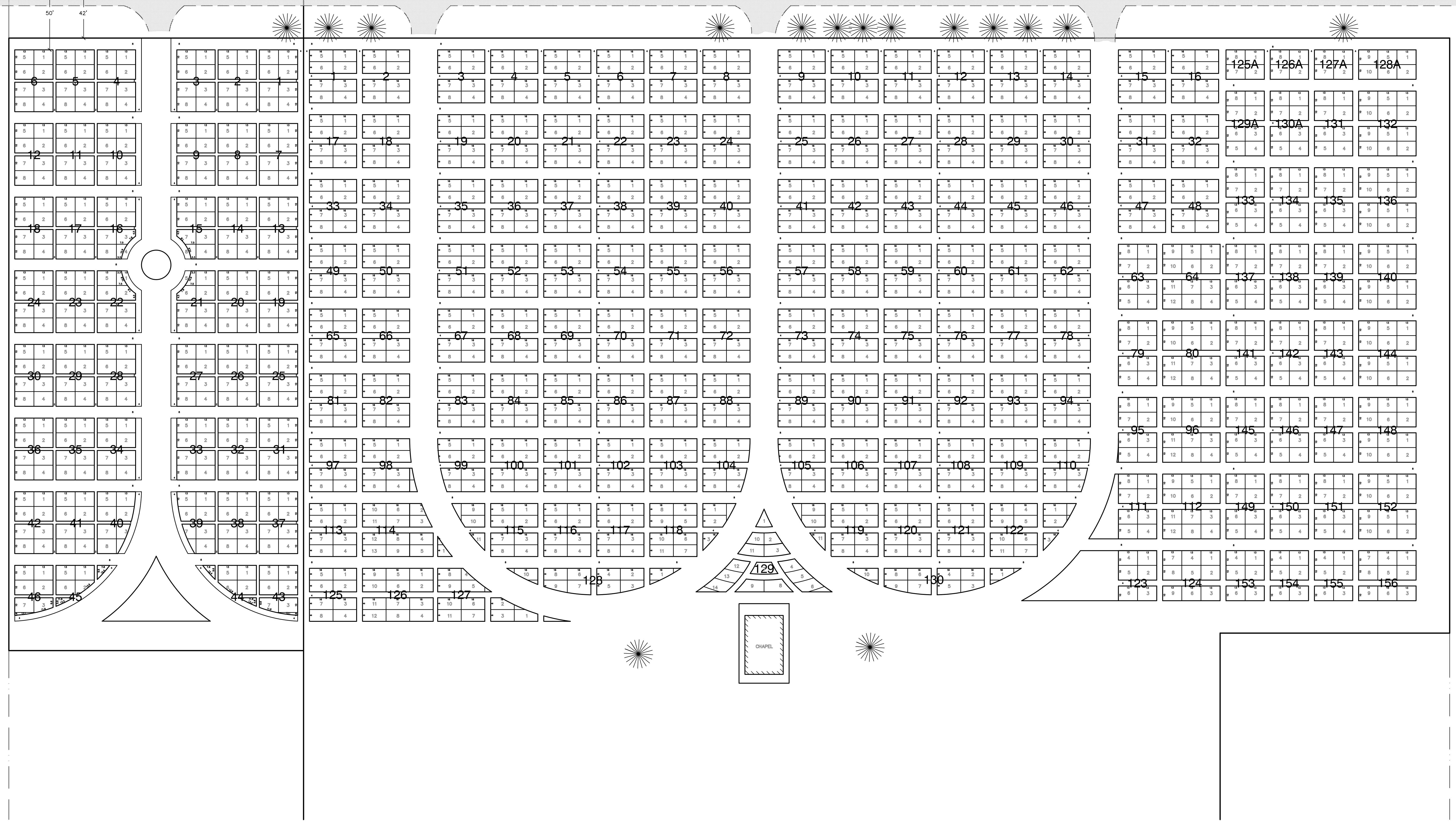

**PHILLIPS ENGINEERING**  
Ph. 810 648-9625 / Fax 648-5922  
Civil Engineering Consultants  
360 East Sanilac, Suite B  
Sandusky, Michigan 48871  
THIS DRAWING IS COPYRIGHT PROTECTED, 2003, PE/PHILLIPS ENGINEERING, LLC